

PLAN OF SURVEY

SCALE 1" = 20'

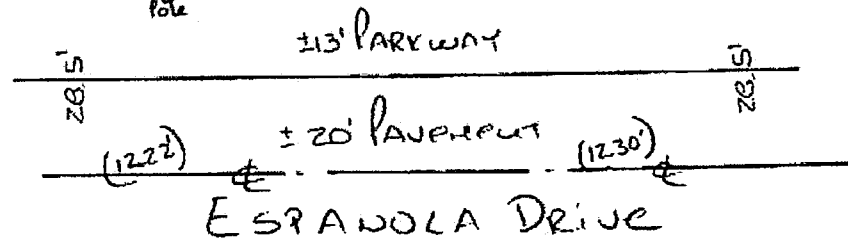
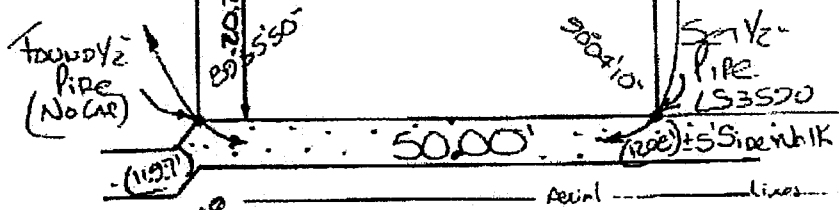
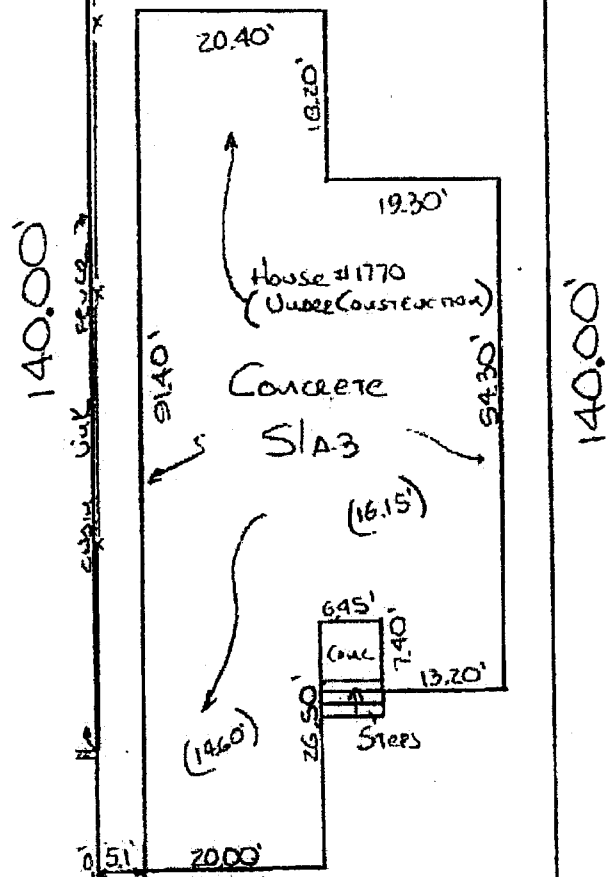
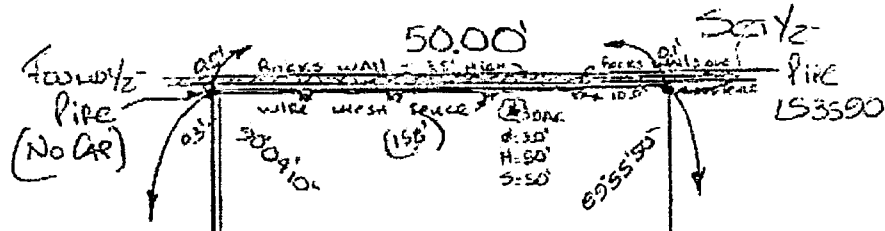

5
4
3
2
1

SLAB ADDED  
09/08/66

REVISIONS  
 A...ARC DISTANCE    A/C...AIR CONDITIONING    CBS...CONCRETE BLOCK STRUCTURE    O.U.L...OVERHEAD UTILITY LINE    CL...CLEAR    C/L...CENTER LINE  
 RAD...RADIAL    ENC...ENCROACHMENT    R/W...RIGHT OF WAY...    FIP...FOUND IRON PIPE    O.H...OVER HEAD    W.M...WATER METER    C.H...CHORD  
 DISTANCE    PL...PROPERTY LINE    CONC...CONCRETE    F.H...FIRE HYDRANT    UP...UTILITY POLE    R...RADIUS    U.E...UTILITY EASEMENT  
 A...CENTRAL ANGLE    R...RADIUS    PL...PLANTER    T...TANGENT    C.B...CATCH BASIN    H: HEIGHT    Ø: DIAMETER    S: SPREAD

Center line of road elevation: 12.30 feet

FEDERAL EMERGENCY MANAGEMENT AGENCY NATIONAL FLOOD INSURANCE PROGRAM

O.M.B. No. 3067-0077

ELEVATION CERTIFICATE

Important: Read the instructions on pages 1 - 7.

SECTION A - PROPERTY OWNER INFORMATION. Includes fields for Building Owner's Name (Grove Homes, LLC), Building Street Address (1770 Espanola Drive), City (Miami), State (Fl.), ZIP Code (33133), and Property Description (Lot 13, Block 3, Espanola Heights, P.B. 11, Pg. 38, Dade County, Florida).

SECTION B - FLOOD INSURANCE RATE MAP (FIRM) INFORMATION. Includes fields for B1. NFIP Community Name & Number (Miami, 120650), B2. County Name (Dade), B3. State (Fl.), B4. Map and Panel Number (12025C0189), B5. Suffix (J), B6. Firm Index Date (07/17/95), B7. Firm Panel Effective/Revised Date (03/02/94), B8. Flood Zone (X), B9. Base Flood Elevation (N/A).

SECTION C - BUILDING ELEVATION INFORMATION (SURVEY REQUIRED)

SECTION C - BUILDING ELEVATION INFORMATION. Includes questions C1-C3 regarding building elevations, datum conversion, and elevation reference marks. Includes a signature box for Lazaro D. Alonso, P.S.M., Land Surveyor No. 3590, State of Florida, dated 09/08/06.

SECTION D - SURVEYOR, ENGINEER, OR ARCHITECT CERTIFICATION

SECTION D - SURVEYOR, ENGINEER, OR ARCHITECT CERTIFICATION. Includes certification text and fields for Certifier's Name (Lazaro D. Alonso), License Number (3590), Title (Professional Surveyor and Mapper (PSM)), Company Name (UNITEC MAPPING AND SURVEYING, INC.), Address (6157 NW 167th. Street # F-15), City (Miami), State (Fl.), ZIP Code (33015), Date (Sept. 08, 2006), and Telephone ((305) 512-4940).

IMPORTANT: In these spaces, copy the corresponding information from Section A.			For Insurance Company Use
BUILDING STREET ADDRESS (Including Apt., Unit, Suite, and/or Bldg. No.) OR P.O. ROUTE AND BOX NO. 1770 Espanola Drive			Policy Number
CITY Miami	STATE Fl.	ZIP CODE 33133	Company NAIC Number

**SECTION D - SURVEYOR, ENGINEER, OR ARCHITECT CERTIFICATION (CONTINUED)**

Copy both sides of this Elevation Certificate for (1) community official, (2) insurance agent/company, and (3) building owner.

COMMENTS

Check here if attachments

**SECTION E - BUILDING ELEVATION INFORMATION (SURVEY NOT REQUIRED) FOR ZONE AO AND ZONE A (WITHOUT BFE)**

For Zone AO and Zone A (without BFE), complete Items E1. through E5. If the Elevation Certificate is intended for use as supporting information for a LOMA or LOMR-F, Section C must be completed.

- E1. Building Diagram Number \_\_\_\_\_ (Select the building diagram most similar to the building for which this certificate is being completed - see pages 6 and 7. If no diagram accurately represents the building, provide a sketch or photograph.)
- E2. The top of the bottom floor (including basement or enclosure) of the building is \_\_\_\_\_ ft. (m) \_\_\_\_\_ in. (cm) \_\_\_\_\_ above or \_\_\_\_\_ below (check one) the highest adjacent grade. (Use natural grade, if available.)
- E3. For Building Diagrams 6-8 with openings (see page 7), the next higher floor or elevated floor (elevation b) of the building is \_\_\_\_\_ ft. (m) \_\_\_\_\_ in. (cm) above the highest adjacent grade. Complete Items C3.h and C3.i on front of form.
- E4. The top of the platform of machinery and/or equipment servicing the building is \_\_\_\_\_ ft. (m) \_\_\_\_\_ in. (cm) \_\_\_\_\_ above or \_\_\_\_\_ below (check one) the highest adjacent grade. (Use natural grade, if available.)
- E5. For Zone AO only: If no flood depth number is available, is the top of the bottom floor elevated in accordance with the community's floodplain management ordinance?  Yes  No  Unknown. The local official must certify this information in Section G.

**SECTION F - PROPERTY OWNER (OR OWNER'S REPRESENTATIVE) CERTIFICATION**

The property owner or owner's authorized representative who completes Sections A, B, C (Items C3.h and C3.i only), and E for Zone A (without a FEMA-issued or community-issued BFE) or Zone AO must sign here. *The statements in Sections A, B, C, and E are correct to the best of my knowledge.*

PROPERTY OWNER'S OR OWNER'S AUTHORIZED REPRESENTATIVE'S NAME  
Lazaro D. Alonso

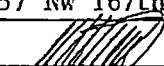
ADDRESS 6157 NW 167th. Street # F-15	CITY Miami	STATE Fl.	ZIP CODE 33015
SIGNATURE 	DATE Sept. 08, 2006	TELEPHONE (305) 512-4940	

COMMENTS

Check here if attachments

**SECTION G - COMMUNITY INFORMATION (OPTIONAL)**

The local official who is authorized by law or ordinance to administer the community's floodplain management ordinance can complete Sections A, B, C (or E), and G of this Elevation Certificate. Complete the applicable item(s) and sign below.

- G1.  The information in Section C was taken from other documentation that has been signed and embossed by a licensed surveyor, engineer, or architect who is authorized by state or local law to certify elevation information. (Indicate the source and date of the elevation data in the Comments area below.)
- G2.  A community official completed Section E for a building located in Zone A (without a FEMA-issued or community-issued BFE) or Zone AO.
- G3.  The following information (Items G4-G9) is provided for community floodplain management purposes.

G4. PERMIT NUMBER	G5. DATE PERMIT ISSUED	G6. DATE CERTIFICATE OF COMPLIANCE/OCCUPANCY ISSUED
-------------------	------------------------	---

G7. This permit has been issued for:  New Construction  Substantial Improvement

G8. Elevation of as-built lowest floor (including basement) of the building is: \_\_\_\_\_ . \_\_\_\_\_ ft. (m) Datum: \_\_\_\_\_

G9. BFE or (in Zone AO) depth of flooding at the building site is: \_\_\_\_\_ . \_\_\_\_\_ ft. (m) Datum: \_\_\_\_\_

LOCAL OFFICIAL'S NAME \_\_\_\_\_ TITLE \_\_\_\_\_

COMMUNITY NAME \_\_\_\_\_ TELEPHONE \_\_\_\_\_

SIGNATURE \_\_\_\_\_ DATE \_\_\_\_\_

COMMENTS

Check here if attachments

IMPORTANT: In these spaces, copy the corresponding information from Section A.			For Insurance Company Use:
BUILDING STREET ADDRESS (Including Apt., Unit, Suite, and/or Bldg. No.) OR P.O. ROUTE AND BOX NO. 1770 Espanola Drive			Policy Number
CITY Miami	STATE Fl.	ZIP CODE 33133	Company NAIC Number

**SECTION D - SURVEYOR, ENGINEER, OR ARCHITECT CERTIFICATION (CONTINUED)**

Copy both sides of this Elevation Certificate for (1) community official, (2) insurance agent/company, and (3) building owner.

COMMENTS

Check here if attachments

**SECTION E - BUILDING ELEVATION INFORMATION (SURVEY NOT REQUIRED) FOR ZONE AO AND ZONE A (WITHOUT BFE)**

For Zone AO and Zone A (without BFE), complete Items E1. through E5. If the Elevation Certificate is intended for use as supporting information for a LOMA or LOMR-F, Section C must be completed.

- E1. Building Diagram Number \_\_\_\_ (Select the building diagram most similar to the building for which this certificate is being completed - see pages 6 and 7. If no diagram accurately represents the building, provide a sketch or photograph.)
- E2. The top of the bottom floor (including basement or enclosure) of the building is \_\_\_\_ ft. (m) \_\_\_\_ in. (cm) \_\_\_\_ above or \_\_\_\_ below (check one) the highest adjacent grade. (Use natural grade, if available.)
- E3. For Building Diagrams 6-8 with openings (see page 7), the next higher floor or elevated floor (elevation b) of the building is \_\_\_\_ ft. (m) \_\_\_\_ in. (cm) above the highest adjacent grade. Complete Items C3.h and C3.i on front of form.
- E4. The top of the platform of machinery and/or equipment servicing the building is \_\_\_\_ ft. (m) \_\_\_\_ in. (cm) \_\_\_\_ above or \_\_\_\_ below (check one) the highest adjacent grade. (Use natural grade, if available.)
- E5. For Zone AO only: If no flood depth number is available, is the top of the bottom floor elevated in accordance with the community's floodplain management ordinance?  Yes  No  Unknown. The local official must certify this information in Section G.

**SECTION F - PROPERTY OWNER (OR OWNER'S REPRESENTATIVE) CERTIFICATION**

The property owner or owner's authorized representative who completes Sections A, B, C (Items C3.h and C3.i only), and E for Zone A (without a FEMA-issued or community-issued BFE) or Zone AO must sign here. *The statements in Sections A, B, C, and E are correct to the best of my knowledge.*

PROPERTY OWNER'S OR OWNER'S AUTHORIZED REPRESENTATIVE'S NAME

Lazaro D. Alonso

ADDRESS: 6157 NW 167th. Street # F-15 CITY: Miami STATE: Fl. ZIP CODE: 33015

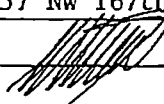
SIGNATURE:  DATE: Sept. 08, 2006 TELEPHONE: (305) 512-4940

COMMENTS

Check here if attachments

**SECTION G - COMMUNITY INFORMATION (OPTIONAL)**

The local official who is authorized by law or ordinance to administer the community's floodplain management ordinance can complete Sections A, B, C (or E), and G of this Elevation Certificate. Complete the applicable item(s) and sign below.

- G1.  The information in Section C was taken from other documentation that has been signed and embossed by a licensed surveyor, engineer, or architect who is authorized by state or local law to certify elevation information. (Indicate the source and date of the elevation data in the Comments area below.)
- G2.  A community official completed Section E for a building located in Zone A (without a FEMA-issued or community-issued BFE) or Zone AO.
- G3.  The following information (Items G4-G9) is provided for community floodplain management purposes.

G4. PERMIT NUMBER	G5. DATE PERMIT ISSUED	G6. DATE CERTIFICATE OF COMPLIANCE/OCCUPANCY ISSUED
-------------------	------------------------	---

G7. This permit has been issued for:  New Construction  Substantial Improvement

G8. Elevation of as-built lowest floor (including basement) of the building is: \_\_\_\_\_ ft. (m) Datum: \_\_\_\_\_

G9. BFE or (in Zone AO) depth of flooding at the building site is: \_\_\_\_\_ ft. (m) Datum: \_\_\_\_\_

LOCAL OFFICIAL'S NAME \_\_\_\_\_ TITLE \_\_\_\_\_

COMMUNITY NAME \_\_\_\_\_ TELEPHONE \_\_\_\_\_

SIGNATURE \_\_\_\_\_ DATE \_\_\_\_\_

COMMENTS

Check here if attachments